

Project reference

BIM RailCare: Virtual logistics planning and simulations

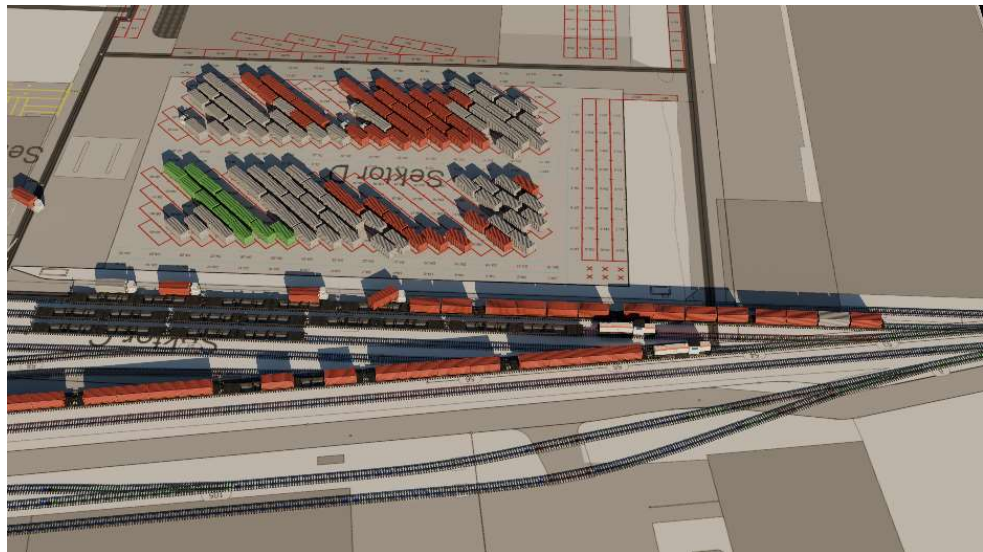

Client

railCare AG
Industriestrasse 17
4612 Wangen b.O

Reference person

Mr Philipp Wegmüller
Project management
Phone: +41 79 335 37 39
e-mail: philipp.wegmueller@railcare.ch

Order total

150'000.00 CHF

Order period

August 2024 - March 2025

Key persons

Order management:	Marcel Nolte
Simulation expert:	Clirim Rudi
Modelling:	Florian Wörz

Project description

As part of the project, the existing planning of handling logistics at the Coop Centre Schafisheim was converted into a visual and comprehensible logistics simulation.

The aim was to digitally map and analyse the following logistics aspects:

- Lorry journeys and manoeuvring movements in the yard area
- Utilisation of the reloading ramps
- Utilisation and capacity limits of intermediate landfills (sectors)
- Identification of logistical bottlenecks and potential collisions

The logistics planning was programmed based on rules and processed to identify optimisation potential. The visualisation also served as a training basis for employees at the logistics centre.

Focal points

- Simulation with 13 yard vehicles and 5 train compositions
- Analysis of container movements, parking options and shunting movements

Results

- Error detection
- Concrete optimisation proposals
- Video documentation

Technical data

- Approx. 800 individual manoeuvres simulated

Special features

- First visual logistics simulation of RailCare
- Simulation services with programmed logics

Our solution

- Logistics simulations with dProb

